



DELIVERED  
DECEMBER 2012



## Rhondda Rescue

### Particulars

Owner	<a href="#">Mooloolaba Coastguard</a>
Home Port	Mooloolaba, Queensland
Design	Mark Ellis Marine Design
Construction	Aluminium
Project Duration	7 months
Length (overall)	14.00 metres
Length (measured)	13.47 metres
Beam (overall)	4.50 metres
Draft	1.25 metres
Crew	12

### Systems

Main Engines	2 x Cummins QSC 8.3 373bkW @ 2,600 rpm
Gearbox	2 x ZF286A 2.20:1
Propulsion	2 x Fixed-pitch propellers
Fuel	2,500 litres
Fresh Water	1 x 200 litres

### Performance

Service	21 knots
Max	26+ knots

### Classification

Hull	AS4132
Machinery	USL/NSCV 2C
Survey	USL/NSCV 2C

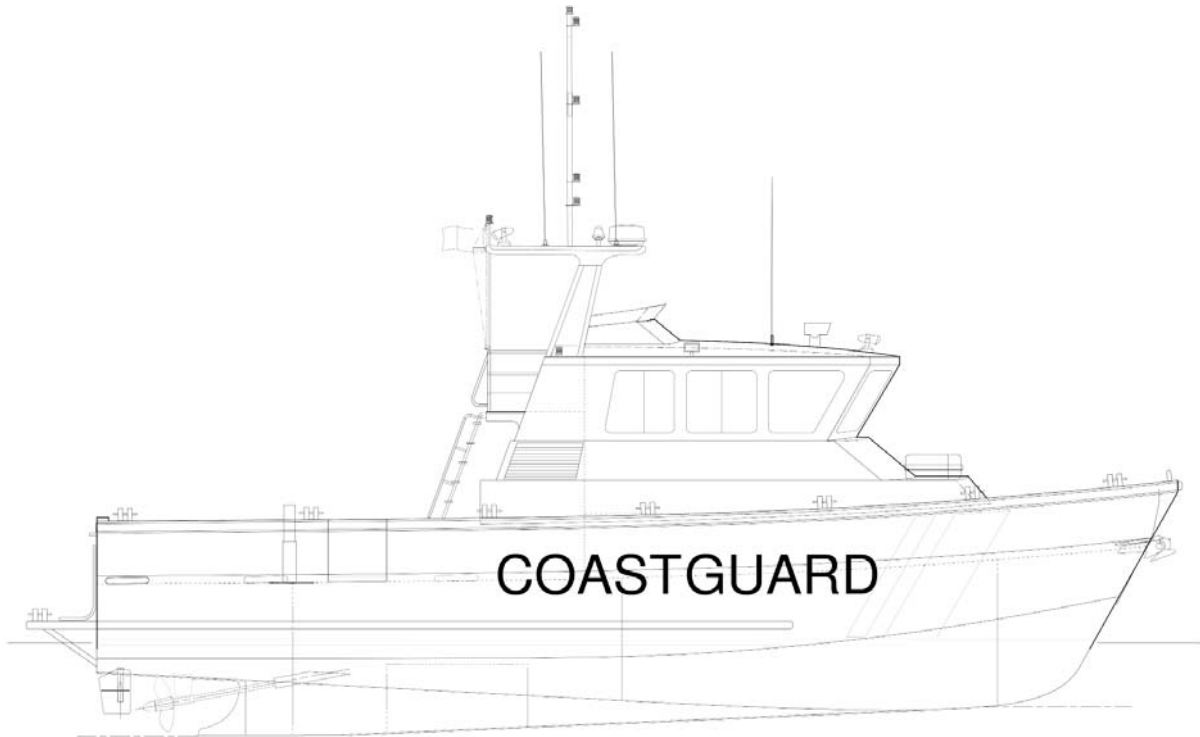

OUTBOARD PROFILE

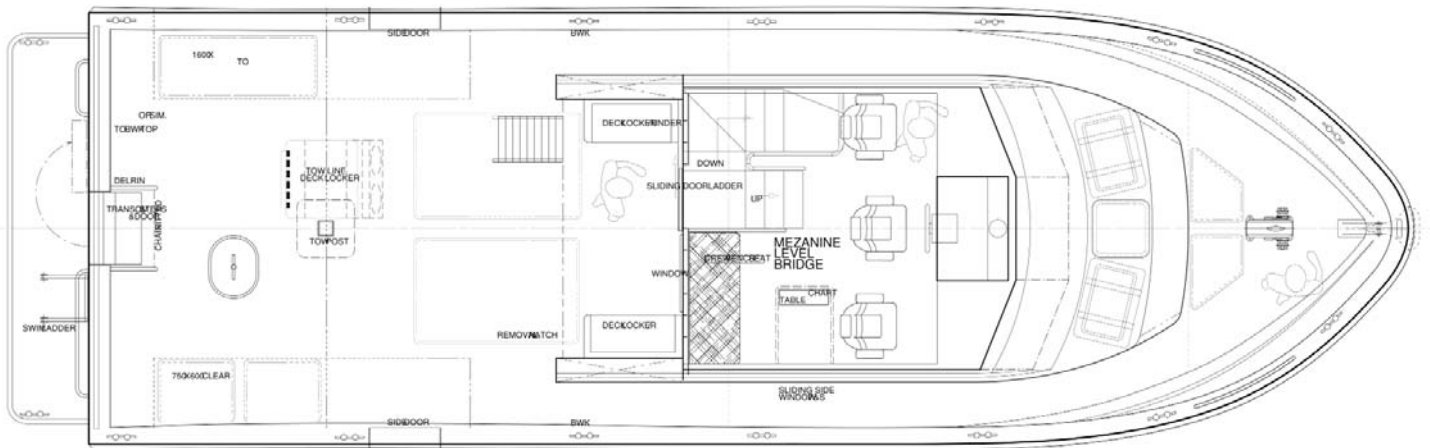

UPPER DECK

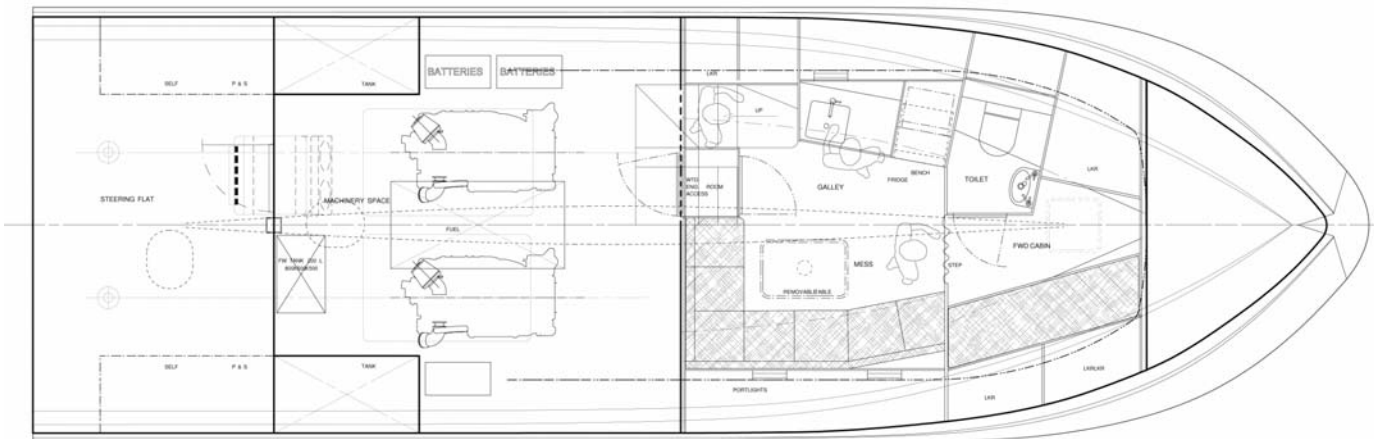

MAIN DECK